



Digitalanzeiger AD72P
72 x 72 mm

- 4-digit digital indicators with 14mm high LED-display
- DIN case 72 x 72 mm
- Input signal 0...1V, 0...10 V or 0/4...20 mA
- Supply voltage for wire transmitter (approx. 18 Vdc)
- Measurement and span digitally adjustable
- 2 floating change
- Outputs: 0...10 V and 0/4...20 mA
- Power supply 24 Vac, 24 Vdc or 230 Vac

4-digit digital display (display range from -999 to 9999) with 14 mm high LED display in DIN case 72 x 72 mm. As the input signal voltages can 0...1 V, 0...10 V or 0/4...20 mA currents are processed. The indicator gives provides a DC voltage for feeding a two-wire-transmitter. An other version provides for the connection of Pt100 resistance in three-wire circuit. The evaluation of the display is digital.

As standard the indicator has two analog output signals of 0...10 V and 0/4...20 mA. As an option, two limits are fitted with floating relay output. The supply of the display can be made with 230 Vac or 24 Vac or 24 Vdc. The scope display, the unit of measure and the measuring point are printed on the front panel.

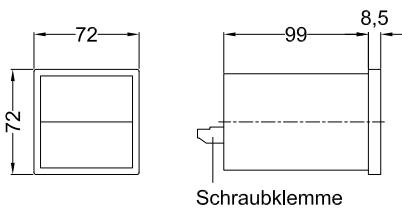

Dimensions (mm)

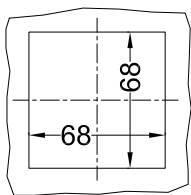

Panel dimension

Specifications

Display: 4-digit red LED-display,
 Range: display extensive: -999...9999, height of digits: 14 mm.
 0...1 V, 0...10 V, 0/4...20 mA
 feeding a two-wire-transmitter
 supply voltage approx. 18 Vdc
 Pt100 in 3-wire, smallest range 20 °C, highest 400 °C

Evaluation of the display: measured beginning and span digital adjustable with buttons
 Solution of the display: max. 10 bit
 Outputs: voltageoutput 0...10 V, max. load 5 mA and current-output 0/4...20 mA, max. burden 600 Ω

Supply voltage: 230 Vac with transformer or 24 Vac or 24 Vdc
 Contacts: 2 potential-free relay
 Ambient-temperature: 0...50 °C no condensation
 Case: fiberglass-reinforced noryl 72 x 72 mm, mounting depth 118 mm / DIN 43700

Weight: approx. 0,5 kg
 Measurement accuracy: 0,2 % v.E. ± 1 digit
 screw terminals
 2 recessed cleats

Accessories/EMC: tested according EN 61000-6-2, EN 61000-6-3, CE mark

Item no.

LED indicator AD72P-ST

4565

Build-in supply voltage for two-wire circuit
 Output: 0...10 V and 0/4...20 mA, supply voltage 230 Vac or 24 Vac

Measurement range, indication range, measuring point labeling: **Customer-specific presetting required!**

LED indicator AD72P-WT

4585

for connection to Pt100 sensors in three-wire circuit
 Output: 0...10 V and 0/4...20 mA, supply voltage 230 Vac or 24 Vac

Measurement range: **Customer-specific presetting required!** = indication range

Measuring point labeling: **Customer-specific presetting required!**

ACCESSORIES

Limit value monitoring GW

45001

2 potential-free relay, contact load 250 Vac, 8 A non-inductive load