



- ❑ Resistance Pt100 class A according DIN 60751
- ❑ Connection head alloy form B
- ❑ Also available with transmitter MU-WBV
- ❑ WBV1R / WBV2R with PTB-licence

Thermoresistance elements for temperature measuring up to max. 400 °C. The measuring element is a precision resistance element Pt100 class A, according DIN 60751.

Specifications

protection tube:	X10CrNiMoTi 1810, 9 mm ϕ , material-no. 1.4571
terminal head:	light alloy B
measuring element:	Pt100 class A according to DIN 43760
temperature:	max. 400 °C

	Order-No.	Price €
Threaded thermoresistance element WBV , with G1/2A in screw, material 1.4571, V4A, terminal head light alloy Typ B, temperature max. 400 °C		
WBV05 immersion depth 50 mm	6235	97,00
WBV10 immersion depth 100 mm	6236	99,00
WBV15 immersion depth 150 mm	6237	101,00
WBV20 immersion depth 200 mm	6238	103,00
WBV25 immersion depth 250 mm	6239	106,00
WBV45 immersion depth 450 mm	6240	108,00

EXTRA CHARGE

Measuring element Pt1000	67110	4,00
Double measuring element Pt100	67111	18,00
High cap	67112	2,00
Transmitter MU-WBV output 4...20 mA	62304	97,00 N
Transmitter MU-WBV-H with HART protocol	62305	275,00 N
Transmitter MU-WBV-P with Profibus PA	62306	318,00 N

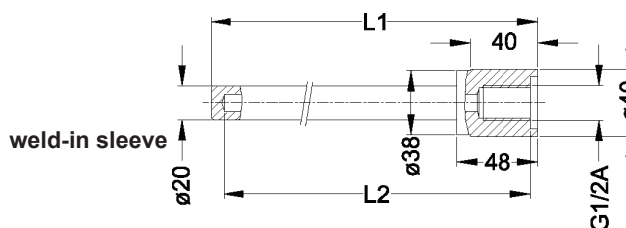
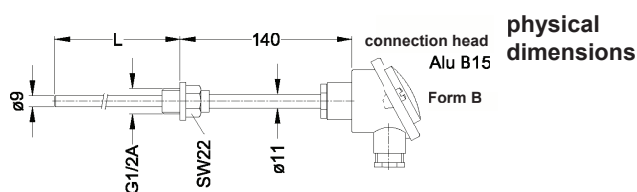

	Order-No.	Price €
Threaded thermoresistance element WBV-R with screw G1/2A, measuring element Pt100, DIN 60751, class A, grouped and numbered in pairs, fast setting, max. temperature 250 °C, PTB-licence up to 160 °C, PTB-certificate no. 22.30, 80.06, max. measuring current 5 mA, particular for differential temperature measurements e.g. on calorimetry		
WBV1R, Nominal length 160 mm	6248	152,00
WBV2R, Nominal length 250 mm	6249	154,00
Weld-in sleeve material steel St37.2, D = 31 mm, d = G1/2A		
B150, Nominal length 150 mm, L1 = 164 mm, L2 = 156 mm	62004	53,00
B160, Nominal length 160 mm, L1 = 174 mm, L2 = 166 mm	62001	54,00
B250, Nominal length 250 mm, L1 = 264 mm, L2 = 256 mm	62002	93,00

Weld-in sleeve made by stainless steel on request